

ASSEMBLY INSTRUCTIONS

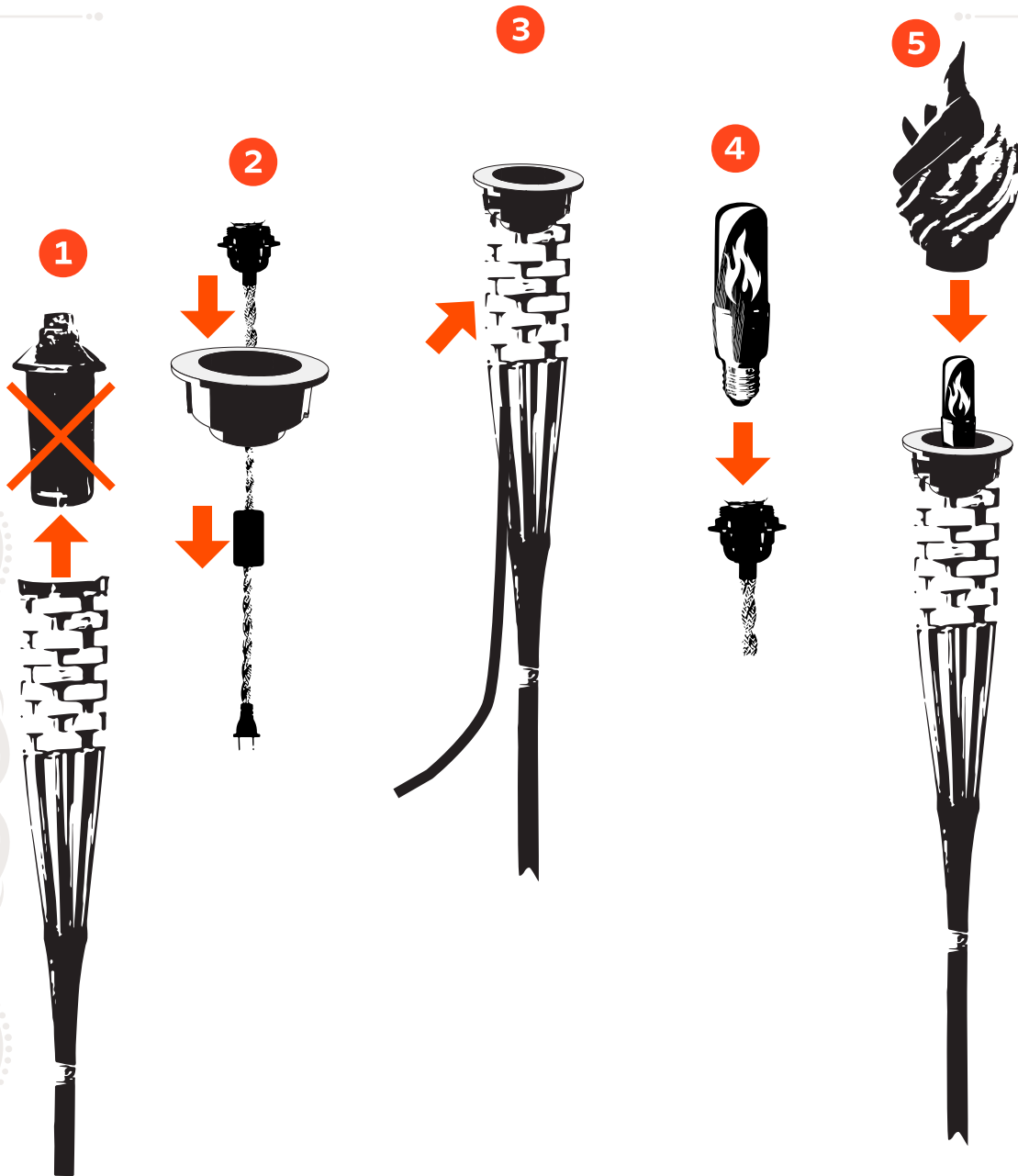

1. Unwrap your standard Tiki-brand torch and remove the fuel canister.
2. Thread the cord through the bulb support cage, then through the torch from the top.
3. Seat the support cage onto the torch basket..
4. Screw the bulb into the socket and settle it into the cage.
5. Place the flame insert over the bulb and settle it firmly into the hole in support cage.
6. Turn on your lamp, and enjoy the forbidden glow.